



HIGH PERFORMANCE TAPS RECOMMENDATION TABLE

Super HSS : Premium HSS Metallurgy

P-HSS : Powdered Metallurgy





HSSE-V3 : 3% Vanadium Alloy HSS-EX

HSS-V : Vanadium Alloy HSS

⊙ = RECOMMENDED

○ = SUITABLE

COOLANT
A = Cutting Oil
T = Oil Emulsion
X = Cutting Oil/Oil Emulsion

							VG	VG	VG	VG	
			SERIES				BB/BI	BH/BM	BF/BK	BD/BO	
			DESCRIPTION				USCTI 302A	USCTI 302A	DIN-ANSI Shank	DIN-ANSI Shank	
HIGH PERFORMANCE TAPS RECOMMENDATION TABLE			PAGE				362	364	365	366	
			THREADS				UNC/UNF	M/MF	UNC/UNF	M/MF	
			TAP MATERIALS				Super HSS	Super HSS	Super HSS	Super HSS	
			CHAMFER LENGTH				2-3P	2-3P	2-3P	2-3P	
			SURFACE TREATMENT				Steam Oxide Hardslick	Steam Oxide Hardslick	Steam Oxide Hardslick	Steam Oxide Hardslick	
			SPIRAL FLUTE ANGLE				R40°	R40°	R40°	R40°	
			THREAD DEPTH				2.5D	2.5D	2.5D	2.5D	
			HOLE TYPE				Blind	Blind	Blind	Blind	
Material Group	Material Sub-Group	ISO	Hardness (HRc)	Hardness (BHN)	Cutting Speed (SFM)		COOLANT				
					Uncoated	Coated					
Steel	Low carbon steels Free machining carbon steels	P	< 15	< 180	25 - 50	50 - 80	T	○	○	○	○
	Medium to high carbon steels Low alloyed steels	P	< 23	< 240	25 - 50	50 - 80	T	⊙	⊙	⊙	⊙
	Steel castings & forgings Heat-treatable alloy steels	P	> 24 ≤ 38	> 250 ≤ 350	6 - 30	10 - 35	X	⊙	⊙	⊙	⊙
	Alloyed tool steels Mold steels	P	> 38 ≤ 44	> 350 ≤ 420	6 - 12	-	A				
Stainless Steel	Free machining stainless steels	M	< 23	< 240	12 - 35	20 - 50	A	○	○	○	○
	Heat-and corrosion-resistant stainless steels Valve stainless steels	M	> 24 ≤ 38	> 250 ≤ 350	12 - 15	12 - 15	A	○	○	○	○
	Stainless steel castings Precipitation hardening stainless steels	M	> 38 ≤ 44	> 350 ≤ 420	12 - 15	-	A				
Cast Iron	Grey cast iron	K	-	≤ 220	35 - 50	50 - 65	T				
	Nodular cast iron / Chilled cast iron Meehanite iron / Ductile iron	K	-	≥ 250	12 - 45	25 - 55	X				
Copper	Pure and alloyed copper	N	-	-	50 - 60	65 - 100	T	○	○	○	○
Brass	Free machining brass Alloyed brass	N	-	-	30 - 65	-	T	○	○	○	○
Bronze		N	44	< 420	12 - 20	35 - 80	T				
Aluminum	Pure Aluminum Aluminum alloys	N	-	-	50 - 65	-	T	○	○	○	○
	Aluminum alloy castings	N	-	-	40 - 65	45 - 90	T				
Zinc		N	-	-	25 - 65	50 - 80	T	○	○	○	○
Magnesium		N	-	-	-	45 - 100	T	○	○	○	○
Nickel Alloys	718 & 625 INCO _n / Waspaloy Hastelloyn / Invar Moneln / Incoloy	S	≤ 38	≤ 350	10 - 15	-	A				
	718 Inconel A286	S	> 38 ≤ 44	> 350 ≤ 420	10 - 12	-	A				
Titanium		S	≤ 38	≤ 350	3 - 15	-	A				

YG SPIRAL FLUTE TAPS

BF / BK SERIES

SPIRAL FLUTE TAPS MODIFIED BOTTOMING STYLE for Steels & Stainless Steels up to 35HRC

Hole type 2.5×D

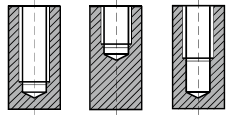

DIN-ANSI Shank

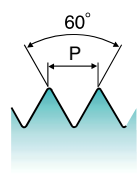

YG
Super HSS
UNC UNF
H2~H6
60°
2P~3P
Steam Oxide
Hardslick
R40

SIZE	Thread Per Inch		Limit	No. of Flute	EDP No.	
	UNC	UNF			Steam Oxide	Hardslick
#2	56	—	H2	2	BF082	BK082
#4	40	—	H2	2	BF162	BK162
#5	40	—	H2	3	BF202	BK202
#6	32	—	H3	3	BF243	BK243
#8	32	—	H3	3	BF283	BK283
#10	24	—	H3	3	BF323	BK323
#10	—	32	H3	3	BF343	BK343
1/4	20	—	H3	3	BF403	BK403
1/4	20	—	H5	3	BF405	BK405
1/4	—	28	H3	3	BF423	BK423
1/4	—	28	H4	3	BF424	BK424
5/16	18	—	H5	3	BF445	BK445
5/16	—	24	H4	3	BF464	BK464
3/8	16	—	H5	3	BF485	BK485
3/8	—	24	H4	3	BF504	BK504
7/16	14	—	H5	3	BF525	BK525
7/16	—	20	H5	3	BF545	BK545
1/2	13	—	H5	3	BF565	BK565
1/2	—	20	H5	3	BF585	BK585
9/16	12	—	H5	3	BF605	BK605
9/16	—	18	H5	3	BF625	BK625
5/8	11	—	H5	4	BF645	BK645
5/8	—	18	H5	4	BF665	BK665
3/4	10	—	H5	4	BF705	BK705
3/4	—	16	H5	4	BF725	BK725
7/8	9	—	H6	4	BF746	BK746
7/8	—	14	H6	4	BF766	BK766
1	8	—	H6	4	BF786	BK786
1	—	12	H6	4	BF806	BK806
1-1/8	8	—	H6	4	BF836	BK836
1-1/4	8	—	H6	4	BF876	BK876
1-3/8	8	—	H6	4	BF916	BK916
1-1/2	8	—	H6	4	BF956	BK956

► For tapping depth on DIN / ANSI Shank Taps, refer to DIN Table on page 493 & 494.

◎ : Excellent ○ : Good

P				M				K		
Low carbon steels/ Free machining carbon steels	Medium to high carbon steels/ Low alloyed steels	Steel castings & forgings / Heat-treatable alloy steels	Alloyed tool steels / Mold steels	Free machining stainless steels	Heat-and corrosionresistant stainless steels / Valve stainless steels	Stainless steel castings / Precipitation hardening stainless steels	Grey cast iron			
○	◎	◎		◎	◎					
K		N				S				
Nodular cast iron / Chilled cast iron / Meehanite iron / Ductile iron	Pure and alloyed copper	Free machining brass / Alloyed brass	Bronze	Pure Aluminum/ Aluminum alloy	Aluminum alloy castings	Zinc	Magnesium	718 & 625 INCO / Waspalloy / Hastelloy / Invar / Monel / Incoloy	718 Inconel / A286	Titanium
	○	○		○		○	○			

- HSS
- CARBIDE
- THREAD MILLS
- COMBO TAPS
- SPIRAL FLUTE TAPS
- SPIRAL POINT TAPS
- STRAIGHT FLUTE TAPS
- FORMING TAPS
- SCREW THREAD INSERT TAPS
- PIPE TAPS
- TECHNICAL DATA



HIGH PERFORMANCE TAPS DIN LENGTH / ANSI SHANK - INCH

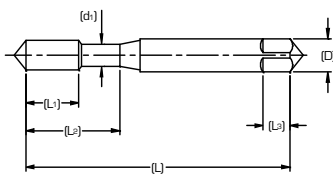

Blank Design (1)

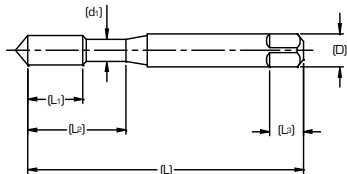

Blank Design (2)

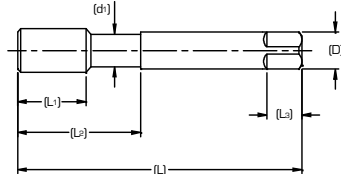

Blank Design (3)

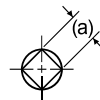

Nominal Size	Overall Length [L]	Thread Length		Length to neck		Shank Diameter [D]	Neck Diameter [d ₁]	Square Length [L ₂]	Square Size [a]	Blank Design No.
		SF	SP	SF	SP					
#2	1.772	.157	.256	.433		.141	.061	.19	.110	1
#3	1.969	.197	.295	.492		.141	.069	.19	.110	1
#4	2.205	.236	.335	.563		.141	.077	.19	.110	1
#5	2.205	.236	.374	.626		.141	.090	.19	.110	1
#6	2.205	.276	.413	.689		.141	.094	.19	.110	1
#8	2.480	.276	.453	.752		.168	.120	.25	.131	1
#10-24	2.756	.354	.531	.906		.194	.131	.25	.152	1
#10-32		.276					.146			1
#12-24	3.150	.354	.571	.906		.220	.157	.28	.165	1
#12-28		.276					.166			1
1/4-20	3.150	.433	.591	1.000		.255	.180	.31	.191	2
1/4-28		.354					.200			2
5/16-18	3.543	.472	.669	1.126		.318	.234	.38	.238	2
5/16-24		.394					.254			2
3/8-16	3.937	.551	.748	1.252		.381	.287	.44	.286	2
3/8-24		.394					.316			2
7/16-14	3.937	.591	.866	1.850	1.437	.323	.311	.41	.242	3
7/16-20		.472								3
1/2-13	4.331	.630	.984	2.067	1.657	.367	.354	.44	.275	3
1/2-20	3.937	.472								3
9/16-12	4.331	.709	.984	2.067	1.657	.429	.417	.50	.322	3
9/16-18	3.937	.512								3
5/8-11	4.331	.748	1.083	2.205	1.811	.480	.469	.56	.360	3
5/8-18	3.937	.512								3
3/4-10	4.921	.827	1.201	2.480	2.000	.590	.577	.69	.442	3
3/4-10	4.331	.591								3
7/8-9	5.512	.827	1.339	2.815	2.220	.697	.685	.75	.523	3
7/8-14	4.921	.709								3
1-8	6.299	.984	1.496	3.091	2.500	.800	.787	.81	.600	3
1-12	5.512	.709								3

*SF : Spiral Fluted Taps

*SP : Spiral Pointed Taps



TAP RECOMMENDATIONS FOR CLASSES OF THREAD - INCH

Internal Screw Thread Classes and Tap Recommendations

Size	Threads per Inch		Recommended Tap for Class of Thread				Pitch Diameter Limits for Class of Thread				
	UNC	UNF	Unified Class of Thread		American National Class of Thread		Min. All Class (Basic)	Unified Class of Thread		American National Class of Thread	
			Class 2	Class 3	Class 2B	Class 3B		Max. Class 2	Max. Class 3	Max. Class 2B	Max. Class 3B
#0	-	80	GH1	GH1	GH2	GH1	.0519	.0536	.0532	.0542	.0536
#1	64	-	GH1	GH1	GH2	GH1	.0629	.0648	.0643	.0655	.0648
#1	-	72	GH1	GH1	GH2	GH1	.0640	.0658	.0653	.0665	.0659
#2	56	-	GH1	GH1	GH2	GH1	.0744	.0764	.0759	.0772	.0765
#2	-	64	GH1	GH1	GH2	GH1	.0759	.0778	.0773	.0786	.0779
#3	48	-	GH1	GH1	GH2	GH1	.0855	.0877	.0871	.0885	.0877
#3	-	56	GH1	GH1	GH2	GH1	.0874	.0894	.8890	.0902	.0895
#4	40	-	GH2	GH1	GH2	GH2	.0958	.0982	.0975	.0991	.0982
#4	-	48	GH1	GH1	GH2	GH1	.0985	.1007	.1001	.1016	.1008
#5	40	-	GH2	GH1	GH2	GH2	.1088	.1112	.1105	.1121	.1113
#5	-	44	GH1	GH1	GH2	GH1	.1102	.1125	.1118	.1134	.1126
#6	32	-	GH2	GH1	GH3	GH2	.1177	.1204	.1196	.1214	.1204
#6	-	40	GH2	GH1	GH2	GH2	.1218	.1242	.1235	.1252	.1243
#8	32	-	GH2	GH1	GH3	GH2	.1437	.1464	.1456	.1475	.1465
#8	-	36	GH2	GH1	GH2	GH2	.1460	.1485	.1478	.1496	.1487
#10	24	-	GH3	GH1	GH3	GH3	.1629	.1662	.1653	.1672	.1661
#10	-	32	GH2	GH1	GH3	GH2	.1697	.1724	.1716	.1736	.1726
#12	24	-	GH3	GH1	GH3	GH3	.1889	.1922	.1913	.1933	.1922
#12	-	28	GH3	GH1	GH3	GH3	.1928	.1959	.1950	.1970	.1959
1/4	20	-	GH3	GH2	GH5	GH3	.2175	.2211	.2201	.2223	.2211
1/4	-	28	GH3	GH1	GH4	GH3	.2268	.2299	.2290	.2311	.2300
5/16	18	-	GH3	GH2	GH5	GH3	.2764	.2805	.2794	.2817	.2803
5/16	-	24	GH3	GH1	GH4	GH3	.2854	.2887	.2878	.2902	.2890
3/8	16	-	GH3	GH2	GH5	GH3	.3344	.3389	.3376	.3401	.3387
3/8	-	24	GH3	GH1	GH4	GH3	.3479	.3512	.3503	.3528	.3516
7/16	14	-	GH5	GH3	GH5	GH3	.3911	.3960	.3947	.3972	.3957
7/16	-	20	GH3	GH1	GH5	GH3	.4050	.4086	.4076	.4104	.4091
1/2	13	-	GH5	GH3	GH5	GH3	.4500	.4552	.4537	.4565	.4548
1/2	-	20	GH3	GH1	GH5	GH3	.4675	.4711	.4701	.4731	.4717
9/16	12	-	GH5	GH3	GH5	GH3	.5084	.5140	.5124	.5152	.5135
9/16	-	18	GH3	GH2	GH5	GH3	.5264	.5305	.5294	.5323	.5308
5/8	11	-	GH5	GH3	GH5	GH3	.5660	.5719	.5702	.5732	.5714
5/8	-	18	GH3	GH2	GH5	GH3	.5889	.5930	.5919	.5949	.5934
3/4	10	-	GH5	GH3	GH5	GH3	.6850	.6914	.6895	.6927	.6907
3/4	-	16	GH3	GH2	GH5	GH3	.7094	.7139	.7126	.7159	.7143
7/8	9	-	GH6	GH4	GH6	GH4	.8028	.8098	.8077	.8110	.8089
7/8	-	14	GH4	GH2	GH6	GH4	.8286	.8335	.8322	.8356	.8339
1	8	-	GH6	GH4	GH6	GH4	.9188	.9264	.9242	.9276	.9254
1	-	12	GH4	GH2	GH6	GH4	.9459	.9515	.9499	.9535	.9516

The above recommended taps normally produce the Class of Thread indicated in average materials when used with reasonable care. However, if the tap specified does not give a satisfactory gage fit in the work, a choice of some other limit tap will be necessary.

15 TAP DRILL SIZES - UNIFIED THREAD

Size	Threads Per Inch				Minor Diameter			Tap Drill Diameter (Cutting Tap)				
	UNC	UNF	UNEF	UN	Min. 2B&3B	Max. 2B	Max. 3B	80% Thread	75% Thread	70% Thread	65% Thread	60% Thread
#0	-	80	-	-	.0465	.0514	.0514	.0470	.0478	.0486	.0494	.0503
#1	64	-	-	-	.0561	.0623	.0623	.0568	.0578	.0588	.0598	.0608
	-	72	-	-	.0580	.0635	.0635	.0586	.0595	.0604	.0613	.0622
#2	56	-	-	-	.0667	.0737	.0737	.0674	.0686	.0698	.0709	.0721
	-	64	-	-	.0691	.0753	.0753	.0698	.0708	.0718	.0728	.0738
#3	48	-	-	-	.0764	.0845	.0845	.0774	.0787	.0801	.0814	.0828
	-	56	-	-	.0797	.0865	.0865	.0804	.0816	.0828	.0839	.0851
#4	40	-	-	-	.0849	.0939	.0939	.0860	.0876	.0893	.0909	.0925
	-	48	-	-	.0894	.0968	.0968	.0904	.0917	.0931	.0944	.0958
#5	40	-	-	-	.0979	.1062	.1062	.0990	.1006	.1023	.1039	.1055
	-	44	-	-	.1004	.1079	.1079	.1014	.1029	.1043	.1058	.1073
#6	32	-	-	-	.1040	.1140	.1140	.1055	.1076	.1096	.1116	.1136
	-	40	-	-	.1110	.1190	.1186	.1120	.1136	.1153	.1169	.1185
#8	32	-	-	-	.1300	.1390	.1389	.1315	.1336	.1356	.1376	.1396
	-	36	-	-	.1340	.1420	.1416	.1351	.1369	.1387	.1405	.1424
#10	24	-	-	-	.1450	.1560	.1555	.1467	.1494	.1521	.1548	.1575
	-	32	-	-	.1560	.1640	.1641	.1575	.1596	.1616	.1636	.1656
#12	24	-	-	-	.1710	.1810	.1807	.1727	.1754	.1781	.1808	.1835
	-	28	-	-	.1770	.1860	.1857	.1789	.1812	.1835	.1858	.1882
1/4	-	-	32	-	.1820	.1900	.1895	.1835	.1856	.1876	.1896	.1916
	20	-	-	-	.1960	.2070	.2067	.1980	.2013	.2045	.2078	.2110
	-	28	-	-	.2110	.2200	.2190	.2129	.2152	.2175	.2198	.2222
5/16	-	-	32	-	.2160	.2240	.2229	.2175	.2196	.2216	.2236	.2256
	18	-	-	-	.2520	.2650	.2630	.2548	.2584	.2620	.2656	.2692
	-	-	-	20	.2580	.2700	.2680	.2605	.2638	.2670	.2703	.2735
	-	24	-	-	.2670	.2770	.2754	.2692	.2719	.2746	.2773	.2800
	-	-	-	28	.2740	.2820	.2807	.2754	.2777	.2800	.2823	.2847
3/8	-	-	32	-	.2790	.2860	.2847	.2800	.2821	.2841	.2861	.2881
	16	-	-	-	.3070	.3210	.3182	.3101	.3141	.3182	.3222	.3263
	-	-	-	20	.3210	.3320	.3297	.3230	.3263	.3295	.3328	.3360
	-	24	-	-	.3300	.3400	.3372	.3317	.3344	.3371	.3398	.3425
	-	-	-	28	.3360	.3450	.3426	.3379	.3402	.3425	.3448	.3472
7/16	-	-	32	-	.3410	.3490	.3469	.3425	.3446	.3466	.3486	.3506
	14	-	-	-	.3600	.3760	.3717	.3633	.3679	.3726	.3772	.3818
	-	-	-	16	.3700	.3840	.3800	.3726	.3766	.3807	.3847	.3888
	-	20	-	-	.3830	.3950	.3916	.3855	.3888	.3920	.3953	.3985
	-	-	28	-	.3990	.4070	.4051	.4004	.4027	.4050	.4073	.4097
1/2	-	-	-	32	.4040	.4110	.4094	.4050	.4071	.4091	.4111	.4131
	13	-	-	-	.4170	.4340	.4284	.4201	.4251	.4301	.4351	.4400
	-	-	-	16	.4320	.4460	.4419	.4351	.4391	.4432	.4472	.4513
	-	20	-	-	.4460	.4570	.4537	.4480	.4513	.4545	.4578	.4610
	-	-	28	-	.4610	.4700	.4676	.4629	.4652	.4675	.4698	.4722
9/16	-	-	-	32	.4660	.4740	.4719	.4675	.4696	.4716	.4736	.4756
	12	-	-	-	.4720	.4900	.4843	.4759	.4813	.4867	.4921	.4976
	-	-	-	16	.4950	.5090	.5040	.4976	.5016	.5057	.5097	.5138
	-	18	-	-	.5020	.5150	.5106	.5048	.5084	.5120	.5156	.5192
	-	-	-	20	.5080	.5200	.5162	.5105	.5138	.5170	.5203	.5235
	-	-	24	-	.5170	.5270	.5244	.5192	.5219	.5246	.5273	.5300
	-	-	-	28	.5240	.5320	.5301	.5254	.5277	.5300	.5323	.5347
5/8	11	-	-	32	.5290	.5360	.5344	.5300	.5321	.5341	.5361	.5381
					.5270	.5460	.5391	.5305	.5364	.5423	.5482	.5541



Size	Threads Per Inch				Minor Diameter			Tap Drill Diameter (Cutting Tap)				
	UNC	UNF	UNEF	UN	Min. 2B&3B	Max. 2B	Max. 3B	80% Thread	75% Thread	70% Thread	65% Thread	60% Thread
5/8	-	-	-	12	.5350	.5530	.5463	.5384	.5438	.5492	.5546	.5601
	-	-	-	16	.5570	.5710	.5662	.5601	.5641	.5682	.5722	.5763
	-	18	-	-	.5650	.5780	.5730	.5673	.5709	.5745	.5781	.5817
	-	-	-	20	.5710	.5820	.5787	.5730	.5763	.5795	.5828	.5860
	-	-	24	-	.5800	.5900	.5869	.5817	.5844	.5871	.5898	.5925
	-	-	-	28	.5860	.5950	.5926	.5879	.5902	.5925	.5948	.5972
11/16	-	-	-	32	.5910	.5980	.5969	.5925	.5946	.5966	.5986	.6006
	-	-	-	12	.5970	.6150	.6085	.6009	.6063	.6117	.6171	.6226
	-	-	-	16	.6200	.6340	.6284	.6226	.6266	.6307	.6347	.6388
	-	-	-	20	.6330	.6450	.6412	.6355	.6388	.6420	.6453	.6485
	-	-	24	-	.6420	.6520	.6494	.6442	.6469	.6496	.6523	.6550
	-	-	-	28	.6490	.6570	.6551	.6504	.6527	.6550	.6573	.6597
3/4	-	-	-	32	.6540	.6610	.6594	.6550	.6571	.6591	.6611	.6631
	10	-	-	-	.6420	.6630	.6545	.6461	.6526	.6591	.6656	.6721
	-	-	-	12	.6600	.6780	.6707	.6634	.6688	.6742	.6796	.6851
	-	16	-	-	.6820	.6960	.6908	.6851	.6891	.6932	.6972	.7013
	-	-	20	-	.6960	.7070	.7037	.6980	.7013	.7045	.7078	.7110
	-	-	-	28	.7110	.7200	.7176	.7129	.7152	.7175	.7198	.7222
13/16	-	-	-	32	.7160	.7240	.7219	.7175	.7196	.7216	.7236	.7256
	-	-	-	12	.7220	.7400	.7329	.7259	.7313	.7367	.7421	.7476
	-	-	-	16	.7450	.7590	.7533	.7476	.7516	.7557	.7597	.7638
	-	-	20	-	.7580	.7700	.7662	.7605	.7638	.7670	.7703	.7735
	-	-	-	28	.7740	.7820	.7801	.7754	.7777	.7800	.7823	.7847
	-	-	-	32	.7790	.7860	.7844	.7800	.7821	.7841	.7861	.7881
7/8	9	-	-	-	.7550	.7780	.7681	.7595	.7668	.7740	.7812	.7884
	-	-	-	12	.7850	.8030	.7948	.7884	.7938	.7992	.8046	.8101
	-	14	-	-	.7980	.8140	.8068	.8008	.8054	.8101	.8147	.8193
	-	-	-	16	.8070	.8210	.8158	.8101	.8141	.8182	.8222	.8263
	-	-	20	-	.8210	.8320	.8287	.8230	.8263	.8295	.8328	.8360
	-	-	-	28	.8360	.8450	.8426	.8379	.8402	.8425	.8448	.8472
15/16	-	-	-	32	.8410	.8490	.8469	.8425	.8446	.8466	.8486	.8506
	-	-	-	12	.8470	.8650	.8575	.8509	.8563	.8617	.8671	.8726
	-	-	-	16	.8700	.8840	.8783	.8726	.8766	.8807	.8847	.8888
	-	-	20	-	.8830	.8950	.8912	.8855	.8888	.8920	.8953	.8985
	-	-	-	28	.8990	.9070	.9051	.9004	.9027	.9050	.9073	.9097
	-	-	-	32	.9040	.9110	.9094	.9050	.9071	.9091	.9111	.9131
1	8	-	-	-	.8650	.8900	.8797	.8701	.8782	.8863	.8945	.9026
	-	12	-	-	.9100	.9280	.9198	.9134	.9188	.9242	.9296	.9351
	-	-	-	16	.9320	.9460	.9408	.9351	.9391	.9432	.9472	.9513
	-	-	20	-	.9460	.9570	.9537	.9480	.9513	.9545	.9578	.9610
	-	-	-	28	.9610	.9700	.9676	.9629	.9652	.9675	.9698	.9722
	-	-	-	32	.9660	.9740	.9719	.9675	.9696	.9716	.9736	.9756
1-1/16	-	-	-	8	.9270	.9520	.9422	.9326	.9407	.9488	.9570	.9651
	-	-	-	12	.9720	.9900	.9823	.9759	.9813	.9867	.9921	.9976
	-	-	-	16	.9950	1.0090	1.0033	.9976	1.0016	1.0057	1.0097	1.0138
	-	-	18	-	1.0020	1.0150	1.0105	1.0048	1.0084	1.0120	1.0156	1.0192
	-	-	-	20	1.0080	1.0200	1.0162	1.0105	1.0138	1.0170	1.0203	1.0235
	-	-	-	28	1.0240	1.0320	1.0301	1.0254	1.0277	1.0300	1.0323	1.0347
1-1/8	7	-	-	-	.9700	.9980	.9875	.9765	.9858	.9951	1.0044	1.0137
	-	-	-	8	.9900	1.0150	1.0047	.9951	1.0032	1.0113	1.0195	1.0276
	-	12	-	-	1.0350	1.0530	1.0448	1.0384	1.0438	1.0492	1.0546	1.0601
	-	-	-	16	1.0570	1.0710	1.0658	1.0601	1.0641	1.0682	1.0722	1.0763
	-	-	18	-	1.0650	1.0780	1.0730	1.0673	1.0709	1.0745	1.0781	1.0817
	-	-	-	20	1.0710	1.0820	1.0787	1.0730	1.0763	1.0795	1.0828	1.0860

Size	Threads Per Inch				Minor Diameter			Tap Drill Diameter (Cutting Tap)				
	UNC	UNF	UNEF	UN	Min. 2B&3B	Max. 2B	Max. 3B	80% Thread	75% Thread	70% Thread	65% Thread	60% Thread
1-1/8	-	-	-	28	1.0860	1.0950	1.0926	1.0879	1.0902	1.0925	1.0948	1.0972
1-3/16	-	-	-	8	1.0520	1.0770	1.0672	1.0576	1.0657	1.0738	1.0820	1.0901
	-	-	-	12	1.0970	1.1150	1.1073	1.1009	1.1063	1.1117	1.1171	1.1226
	-	-	-	16	1.1200	1.1340	1.1283	1.1226	1.1266	1.1307	1.1347	1.1388
	-	-	18	-	1.1270	1.1400	1.1355	1.1298	1.1334	1.1370	1.1406	1.1442
	-	-	-	20	1.1330	1.1450	1.1412	1.1355	1.1388	1.1420	1.1453	1.1485
	-	-	-	28	1.1490	1.1570	1.1551	1.1504	1.1527	1.1550	1.1573	1.1597
1-1/4	7	-	-	-	1.0950	1.1230	1.1125	1.1015	1.1108	1.1201	1.1294	1.1387
	-	-	-	8	1.1150	1.1400	1.1297	1.1201	1.1282	1.1363	1.1445	1.1526
	-	12	-	-	1.1600	1.1780	1.1698	1.1634	1.1688	1.1742	1.1796	1.1851
	-	-	-	16	1.1820	1.1960	1.1908	1.1851	1.1891	1.1932	1.1972	1.2013
	-	-	18	-	1.1900	1.2030	1.1980	1.1923	1.1959	1.1995	1.2031	1.2067
	-	-	-	20	1.1960	1.2070	1.2037	1.1980	1.2013	1.2045	1.2078	1.2110
1-5/16	-	-	-	28	1.2110	1.2200	1.2176	1.2129	1.2152	1.2175	1.2198	1.2222
	-	-	-	8	1.1770	1.2020	1.2176	1.1826	1.1907	1.1988	1.2070	1.2151
	-	-	-	12	1.2220	1.2400	1.2323	1.2259	1.2313	1.2367	1.2421	1.2476
	-	-	-	16	1.2450	1.2590	1.2533	1.2476	1.2516	1.2557	1.2597	1.2638
	-	-	18	-	1.2520	1.2650	1.2605	1.2548	1.2584	1.2620	1.2656	1.2692
	-	-	-	20	1.2580	1.2700	1.2662	1.2605	1.2638	1.2670	1.2703	1.2735
1-3/8	-	-	-	28	1.2740	1.2820	1.2801	1.2754	1.2777	1.2800	1.2823	1.2847
	6	-	-	-	1.1950	1.2250	1.2146	1.2018	1.2126	1.2235	1.2343	1.2451
	-	-	-	8	1.2400	1.2650	1.2547	1.2451	1.2532	1.2613	1.2695	1.2776
	-	12	-	-	1.2850	1.3030	1.2948	1.2884	1.2938	1.2992	1.3046	1.3101
	-	-	-	16	1.3070	1.3210	1.3158	1.3101	1.3141	1.3182	1.3222	1.3263
	-	-	18	-	1.3150	1.3280	1.3230	1.3173	1.3209	1.3245	1.3281	1.3317
1-7/16	-	-	-	20	1.3210	1.3320	1.3287	1.3230	1.3263	1.3295	1.3328	1.3360
	-	-	-	28	1.3360	1.3450	1.3426	1.3379	1.3402	1.3425	1.3448	1.3472
	-	-	-	6	1.2570	1.2880	1.2770	1.2643	1.2751	1.2860	1.2968	1.3076
	-	-	-	8	1.3020	1.3270	1.3172	1.3076	1.3157	1.3238	1.3320	1.3401
	-	-	-	12	1.3470	1.3650	1.3573	1.3509	1.3563	1.3617	1.3671	1.3726
	-	-	-	16	1.3700	1.3840	1.3783	1.3726	1.3766	1.3807	1.3847	1.3888
1-1/2	-	-	18	-	1.3770	1.3900	1.3855	1.3798	1.3834	1.3870	1.3906	1.3942
	-	-	-	20	1.3830	1.3950	1.3912	1.3855	1.3888	1.3920	1.3953	1.3985
	-	-	-	28	1.3990	1.4070	1.4051	1.4004	1.4027	1.4050	1.4073	1.4097
	6	-	-	-	1.3200	1.3500	1.3396	1.3268	1.3376	1.3485	1.3593	1.3701
	-	-	-	8	1.3650	1.3900	1.3797	1.3701	1.3782	1.3863	1.3945	1.4026
	-	12	-	-	1.4100	1.4280	1.4198	1.4134	1.4188	1.4242	1.4296	1.4351
1-9/16	-	-	-	16	1.4320	1.4460	1.4408	1.4351	1.4391	1.4432	1.4472	1.4513
	-	-	18	-	1.4400	1.4520	1.4480	1.4423	1.4459	1.4495	1.4531	1.4567
	-	-	-	20	1.4460	1.4570	1.4537	1.4480	1.4513	1.4545	1.4578	1.4610
	-	-	-	28	1.4610	1.4700	1.4676	1.4629	1.4652	1.4675	1.4698	1.4722
	-	-	-	6	1.3820	1.4130	1.4021	1.3893	1.4001	1.4110	1.4218	1.4326
	-	-	-	8	1.4270	1.4520	1.4422	1.4326	1.4407	1.4488	1.4570	1.4651
1-5/8	-	-	-	12	1.4720	1.4900	1.4823	1.4759	1.4813	1.4867	1.4921	1.4976
	-	-	-	16	1.4950	1.5090	1.5033	1.4976	1.5016	1.5057	1.5097	1.5138
	-	-	18	-	1.5020	1.5150	1.5105	1.5048	1.5084	1.5120	1.5156	1.5192
	-	-	-	20	1.5080	1.5200	1.5162	1.5105	1.5138	1.5170	1.5203	1.5235
	-	-	-	6	1.4450	1.4750	1.4646	1.4518	1.4626	1.4735	1.4843	1.4951
	-	-	-	8	1.4900	1.5150	1.5047	1.4951	1.5032	1.5113	1.5195	1.5276
1-11/16	-	-	-	12	1.5350	1.5530	1.5448	1.5384	1.5438	1.5492	1.5546	1.5601
	-	-	-	16	1.5570	1.5710	1.5658	1.5601	1.5641	1.5682	1.5722	1.5763
	-	-	18	-	1.5650	1.5780	1.5730	1.5673	1.5709	1.5745	1.5781	1.5817
	-	-	-	20	1.5710	1.5820	1.5787	1.5730	1.5763	1.5795	1.5828	1.5860
1-11/16	-	-	6	1.5070	1.5380	1.5271	1.5143	1.5251	1.5360	1.5468	1.5576	



Size	Threads Per Inch				Minor Diameter			Tap Drill Diameter (Cutting Tap)				
	UNC	UNF	UNEF	UN	Min. 2B&3B	Max. 2B	Max. 3B	80% Thread	75% Thread	70% Thread	65% Thread	60% Thread
1-11/16	-	-	-	8	1.5520	1.5770	1.5672	1.5576	1.5657	1.5738	1.5820	1.5901
	-	-	-	12	1.5970	1.6150	1.6073	1.6009	1.6063	1.6117	1.6171	1.6226
	-	-	-	16	1.6200	1.6340	1.6283	1.6226	1.6266	1.6307	1.6347	1.6388
	-	-	18	-	1.6270	1.6400	1.6355	1.6298	1.6334	1.6370	1.6406	1.6442
	-	-	-	20	1.6330	1.6450	1.6412	1.6355	1.6388	1.6420	1.6453	1.6485
1-3/4	5	-	-	-	1.5340	1.5680	1.5575	1.5422	1.5552	1.5681	1.5811	1.5941
	-	-	-	6	1.5700	1.6000	1.5896	1.5768	1.5876	1.5985	1.6093	1.6201
	-	-	-	8	1.6150	1.6400	1.6297	1.6201	1.6282	1.6363	1.6445	1.6526
	-	-	-	12	1.6600	1.6780	1.6698	1.6634	1.6688	1.6742	1.6796	1.6851
	-	-	-	16	1.6820	1.6960	1.6908	1.6851	1.6891	1.6932	1.6972	1.7013
1-13/16	-	-	-	20	1.6960	1.7070	1.7037	1.6980	1.7013	1.7045	1.7078	1.7110
	-	-	-	6	1.6320	1.6630	1.6521	1.6393	1.6501	1.6610	1.6718	1.6826
	-	-	-	8	1.6770	1.7020	1.6922	1.6826	1.6907	1.6988	1.7070	1.7151
	-	-	-	12	1.7220	1.7400	1.7323	1.7259	1.7313	1.7367	1.7421	1.7476
	-	-	-	16	1.7450	1.7590	1.7533	1.7476	1.7516	1.7557	1.7597	1.7638
1-7/8	-	-	-	20	1.7580	1.7700	1.7662	1.7605	1.7638	1.7670	1.7703	1.7735
	-	-	-	6	1.6950	1.7250	1.7146	1.7018	1.7126	1.7235	1.7343	1.7451
	-	-	-	8	1.7400	1.7650	1.7547	1.7451	1.7532	1.7613	1.7695	1.7776
	-	-	-	12	1.7850	1.8030	1.7948	1.7884	1.7938	1.7992	1.8046	1.8101
	-	-	-	16	1.8070	1.8210	1.8158	1.8101	1.8141	1.8182	1.8222	1.8263
1-15/16	-	-	-	20	1.8210	1.8320	1.8287	1.8230	1.8263	1.8295	1.8328	1.8360
	-	-	-	6	1.7570	1.7880	1.7771	1.7643	1.7751	1.7860	1.7968	1.8076
	-	-	-	8	1.8020	1.8270	1.8172	1.8076	1.8157	1.8238	1.8320	1.8401
	-	-	-	12	1.8470	1.8650	1.8573	1.8509	1.8563	1.8617	1.8671	1.8726
	-	-	-	16	1.8700	1.8840	1.8783	1.8726	1.8766	1.8807	1.8847	1.8888
2	-	-	-	20	1.8830	1.8950	1.8912	1.8855	1.8888	1.8920	1.8953	1.8985
	4 1/2	-	-	-	1.7590	1.7950	1.7861	1.7691	1.7835	1.7979	1.8124	1.8268
	-	-	-	6	1.8200	1.8500	1.8396	1.8268	1.8376	1.8485	1.8593	1.8701
	-	-	-	8	1.8650	1.8900	1.8797	1.8701	1.8782	1.8863	1.8945	1.9026
	-	-	-	12	1.9100	1.9280	1.9198	1.9134	1.9188	1.9242	1.9296	1.9351
2-1/8	-	-	-	16	1.9320	1.9460	1.9408	1.9351	1.9391	1.9432	1.9472	1.9513
	-	-	-	20	1.9460	1.9570	1.9537	1.9480	1.9513	1.9545	1.9578	1.9610
	-	-	-	6	1.9450	1.9750	1.9646	1.9518	1.9626	1.9735	1.9843	1.9951
	-	-	-	8	1.9900	2.0150	2.0047	1.9951	2.0032	2.0113	2.0195	2.0276
	-	-	-	12	2.0350	2.0530	2.0448	2.0384	2.0438	2.0492	2.0546	2.0601
2-1/4	-	-	-	16	2.0570	2.0710	2.0658	2.0601	2.0641	2.0682	2.0722	2.0763
	-	-	-	20	2.0710	2.0820	2.0787	2.0730	2.0763	2.0795	2.0828	2.0860
	4 1/2	-	-	-	2.0090	2.0450	2.0361	2.0191	2.0335	2.0479	2.0624	2.0768
	-	-	-	6	2.0700	2.1000	2.0896	2.0768	2.0876	2.0985	2.1093	2.1201
	-	-	-	8	2.1150	2.1400	2.1297	2.1201	2.1282	2.1363	2.1445	2.1526
2-3/8	-	-	-	12	2.1600	2.1780	2.1698	2.1634	2.1688	2.1742	2.1796	2.1851
	-	-	-	16	2.1820	2.1960	2.1908	2.1851	2.1891	2.1932	2.1972	2.2013
	-	-	-	20	2.1960	2.2070	2.2037	2.1980	2.2013	2.2045	2.2078	2.2110
	-	-	-	6	2.1950	2.2260	2.2146	2.2018	2.2126	2.2235	2.2343	2.2451
	-	-	-	8	2.2400	2.2650	2.2547	2.2451	2.2532	2.2613	2.2695	2.2776
2-1/2	-	-	-	12	2.2850	2.3030	2.2948	2.2884	2.2938	2.2992	2.3046	2.3101
	-	-	-	16	2.3070	2.3210	2.3158	2.3101	2.3141	2.3182	2.3222	2.3263
	-	-	-	20	2.3210	2.3320	2.3287	2.3230	2.3263	2.3295	2.3328	2.3360
	4	-	-	-	2.2290	2.2670	2.2594	2.2402	2.2564	2.2727	2.2889	2.3052
	-	-	-	6	2.3200	2.3500	2.3396	2.3268	2.3376	2.3485	2.3593	2.3701
2-1/2	-	-	-	8	2.3650	2.3900	2.3797	2.3701	2.3782	2.3863	2.3945	2.4026
	-	-	-	12	2.4100	2.4280	2.4198	2.4134	2.4188	2.4242	2.4296	2.4351
	-	-	-	16	2.4320	2.4460	2.4408	2.4351	2.4391	2.4432	2.4472	2.4513
	-	-	-	20	2.4460	2.4570	2.4537	2.4480	2.4513	2.4545	2.4578	2.4610