

CARBIDE, 4 FLUTE REGULAR LENGTH BALL NOSE

- ▶ Special flute geometry eliminates vibrations
- ▶ Designed for mild steels, stainless steel, cast iron, tool steels, titanium alloys, prehardened steels and low hardness material
- ▶ Excellent work piece finishes
- ▶ Higher speeds, deeper cuts and metal removal rates



MG 4 R ±.0004" PLAIN FLAT P.688

◆ U.S.A Stock

Unit : Inch

EDP No.		Radius of Ball Nose	Mill Diameter	Shank Diameter	Length of Cut	Overall Length
PLAIN	FLAT	R (±.0004)				
EMB78008	-	R1/16	1/8	1/8	3/8	1-1/2
EMB78010	-	R5/64	5/32	3/16	7/16	2
EMB78012	-	R3/32	3/16	3/16	7/16	2
EMB78016	-	R1/8	1/4	1/4	1/2	2-1/2
EMB78020	-	R5/32	5/16	5/16	13/16	2-1/2
-	EMB79024	R3/16	3/8	3/8	7/8	2-1/2
-	EMB79032	R1/4	1/2	1/2	1	3
-	EMB79040	R5/16	5/8	5/8	1-1/4	3-1/2
-	EMB79048	R3/8	3/4	3/4	1-1/2	4
-	EMB79064	R1/2	1	1	1-1/2	4

▶ Shanks 3/8" and over come standard with Flats.

Mill Dia. Tolerance (inch)	Shank Dia. Tolerance
0~-.0012	h6

◎ : Excellent ○ : Good

Carbon Steels	Alloy Steels	Pehardened Steels	Hardened Steels		High Hardened Steels	Copper	Graphite	Cast Iron	Aluminum	Stainless Steels	Titanium	Inconel
~HRc20	HRc20~30	HRc30~40	HRc40~45	HRc45~55	HRc55~70							
◎	○	○								◎	◎	○

CBN END MILL

i-Xmill END MILL

X5070 END MILLS

4G MILLS END MILLS

X-SPEED ROUGHER END MILLS

X-POWER END MILLS

JET-POWER END MILLS

V7 Mill STEEL END MILLS

V7 Mill INOX END MILLS

ALU-POWER END MILLS

D-POWER END MILLS

STANDARD CARBIDE END MILLS

TANK-POWER END MILLS

STANDARD COBALT & HSS END MILLS

TECHNICAL DATA



**V7 Mill INOX
END MILLS**

RECOMMENDED CUTTING CONDITIONS

CBN
END MILL

i-Xmill
END MILL

X5070
END MILLS

4G MILLS
END MILLS

X-SPEED
ROUGHER
END MILLS

X-POWER
END MILLS

JET-POWER
END MILLS

V7 Mill STEEL
END MILLS

V7 Mill INOX
END MILLS

ALU-POWER
END MILLS

D-POWER
END MILLS

STANDARD
CARBIDE
END MILLS

TANK-POWER
END MILLS

STANDARD
COBALT
& HSS
END MILLS

TECHNICAL
DATA

CARBIDE, 4 FLUTE BALL NOSE

EMB74, EMB75, EMB78, EMB79 SERIES

MATERIAL	ALLOY STEELS CAST IRON		STAINLESS STEELS 300SERIES		STAINLESS STEELS 400SERIES		TITANIUM		INCONEL	
HARDNESS	~HRc 20									
STRENGTH	~1000N/mm ²									
DIAMETER	RPM	FEED	RPM	FEED	RPM	FEED	RPM	FEED	RPM	FEED
1/8	13530	53.2	7770	24.2	7020	16.4	5510	10.4	3010	5.2
3/16	9020	42.6	5180	20.3	4680	18.2	3680	8.7	2010	3.3
1/4	6770	40.7	3880	24.9	3510	16.4	2760	8.6	1500	3.7
5/16	5410	50.8	3110	21.9	2810	17.5	2210	10.4	1200	4.8
3/8	4510	42.6	2590	20.3	2340	16.6	1840	8.7	1000	4.2
7/16	3870	39.5	2220	18.3	2010	15.0	1580	8.6	860	4.4
1/2	3380	37.2	1940	16.8	1750	13.8	1380	8.6	750	4.5
9/16	3010	34.2	1730	15.6	1560	12.8	1230	8.0	670	4.5
5/8	2710	31.8	1550	14.7	1400	11.9	1100	7.6	600	4.4
3/4	2260	32.0	1290	13.3	1170	10.8	920	8.7	500	4.2
1	1690	26.5	970	10.7	880	8.2	690	7.4	380	3.1

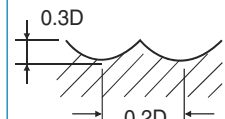
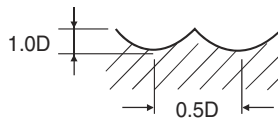

RPM = rev./min.
FEED = inch/min.

CARBIDE, 5 FLUTE

EMB72, EMB73, EMB76, EMB77 SERIES

MATERIAL	ALLOY STEELS CAST IRON		STAINLESS STEELS 300SERIES		STAINLESS STEELS 400SERIES		TITANIUM		INCONEL	
HARDNESS	~HRc 20									
STRENGTH	~1000N/mm ²									
DIAMETER	RPM	FEED	RPM	FEED	RPM	FEED	RPM	FEED	RPM	FEED
1/4	6870	46.1	5710	34.2	5310	31.8	4200	24.9	1350	4.4
5/16	5490	41.3	4570	28.6	4250	26.5	3360	20.6	1080	4.3
3/8	4580	45.5	3810	28.5	3540	26.3	2800	20.7	900	4.5
7/16	3920	44.0	3270	32.6	3040	23.9	2400	20.8	770	4.7
1/2	3430	42.8	2860	35.7	2660	22.1	2100	20.8	680	4.8
9/16	3050	41.7	2540	32.7	2360	29.6	1860	20.9	600	5.4
5/8	2750	41.4	2290	30.9	2130	28.4	1680	20.7	540	5.1
3/4	2290	39.6	1900	28.6	1770	26.4	1400	20.7	450	5.4
1	1720	34.2	1430	24.8	1330	23.2	1050	18.3	340	5.1

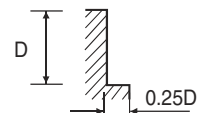
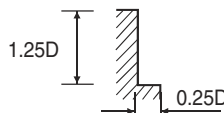

RPM = rev./min.
FEED = inch/min.